

Accessing Microsoft Teams

Instructions

Accessing Microsoft Teams

You can access “Microsoft Teams” by going to my.littleover.derby.sch.uk through your internet browser and clicking on the **Microsoft Teams** tile.



Once the page loads you will need to enter your school email address and click **next**.

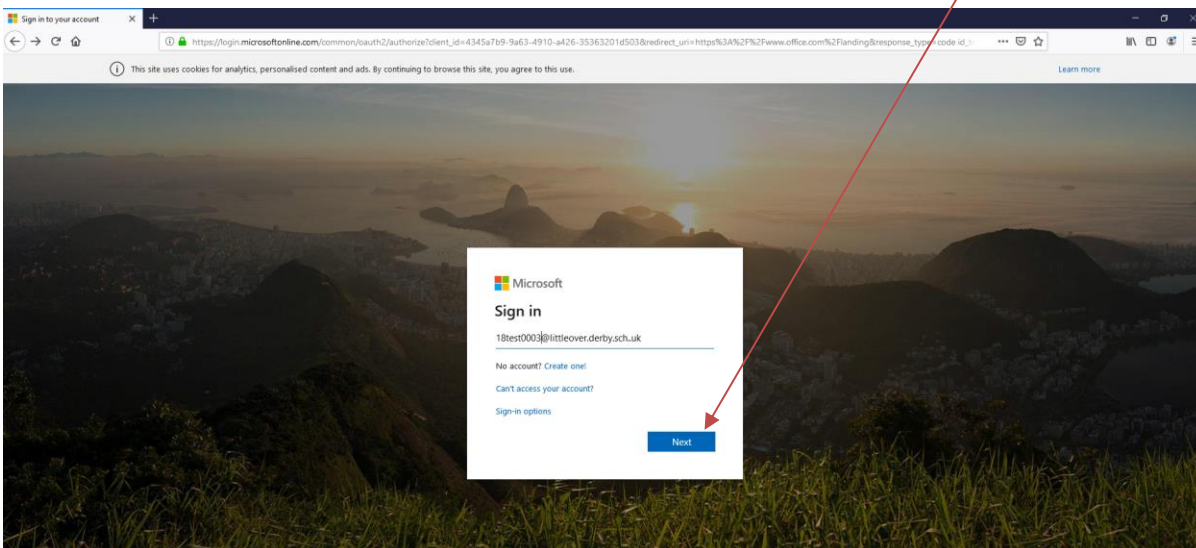

After doing this you will need to enter your password and click **Sign In**. This is the same password you use to sign in to the school computers.

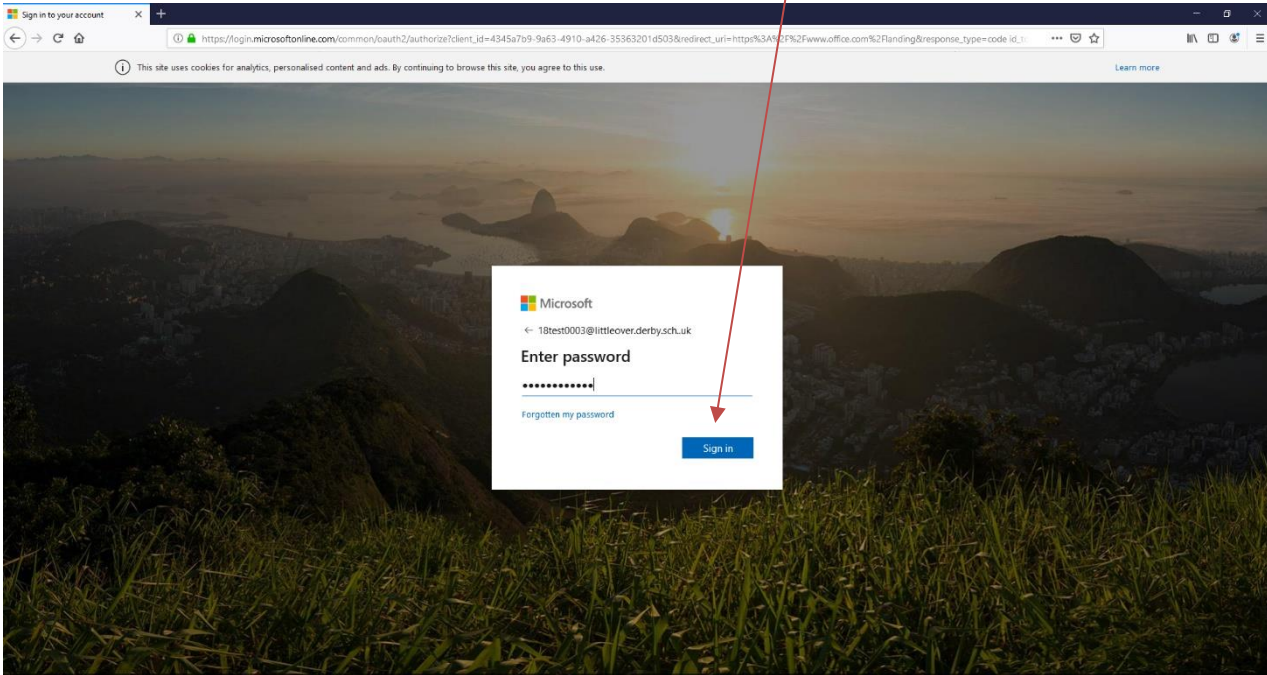

You will then be taken to your Microsoft Teams homepage.

